

Last modified date	Author	Part	Contact
2015-11-26	Kim sun ah	Development	Say2718@vaultmicro..com

## FAQ : Sony Xperia Z3

### **Q : CamerFi doesn't work!**

Many Sony Xperia Z series users left comments that CameraFi doesn't work. CameraFi team has analyzed the problem and as a result, we found out that you have to set settings for USB connectivity in Z3.

If you follow the steps below, you will be able to use CameraFi.

1. Go to your smartphone settings. -> Touch 'Xperia Connectivity' menu.

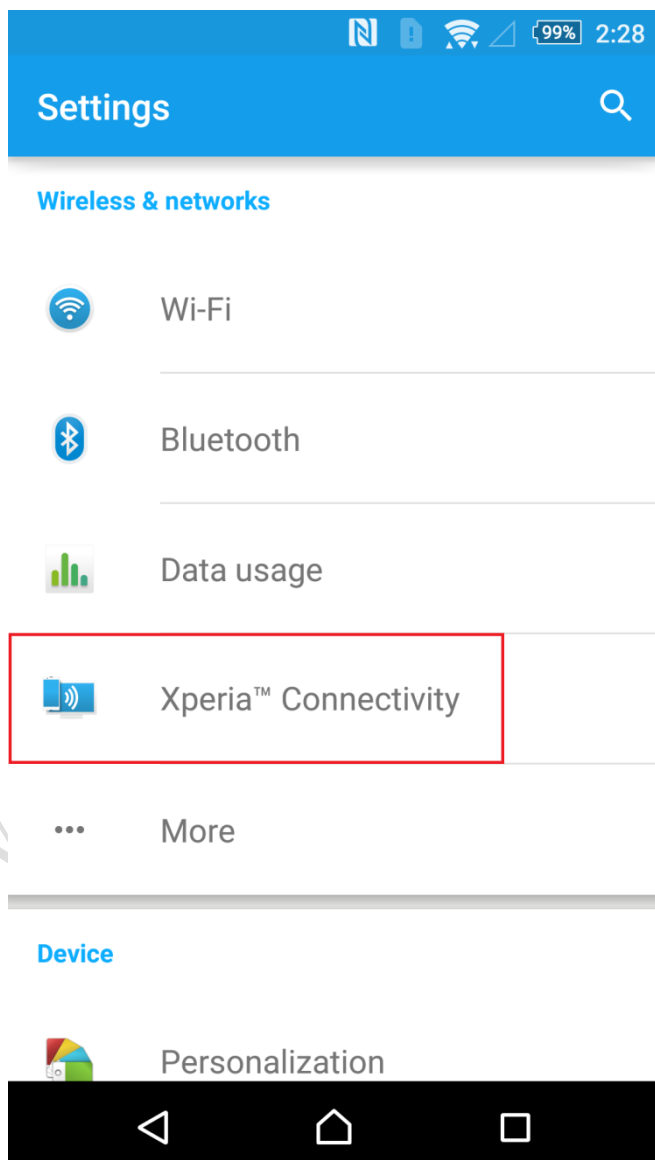

Last modified date	Author	Part	Contact
2015-11-26	Kim sun ah	Development	Say2718@vaultmicro..com

2. Touch 'USB Connectivity' menu.

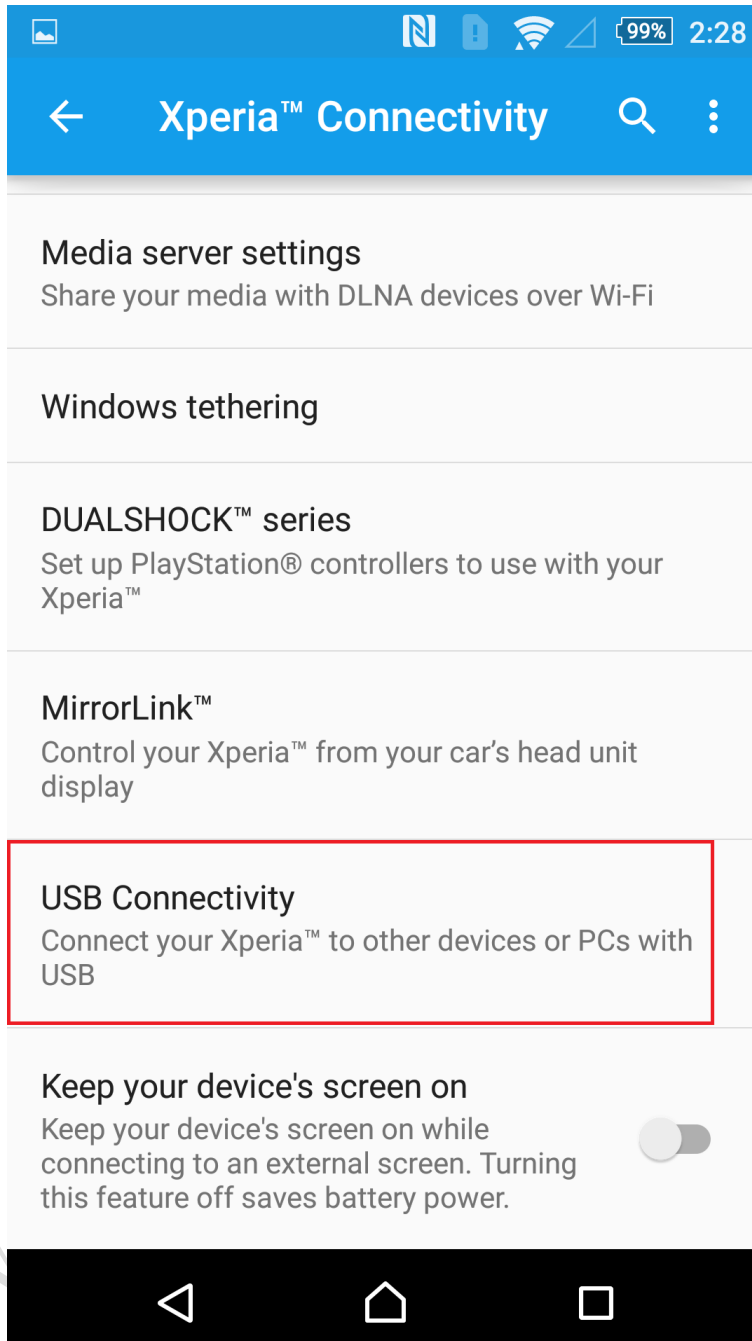

Last modified date	Author	Part	Contact
2015-11-26	Kim sun ah	Development	Say2718@vaultmicro..com

3. Touch 'Detect USB device' menu. -> Connect to USB camera.

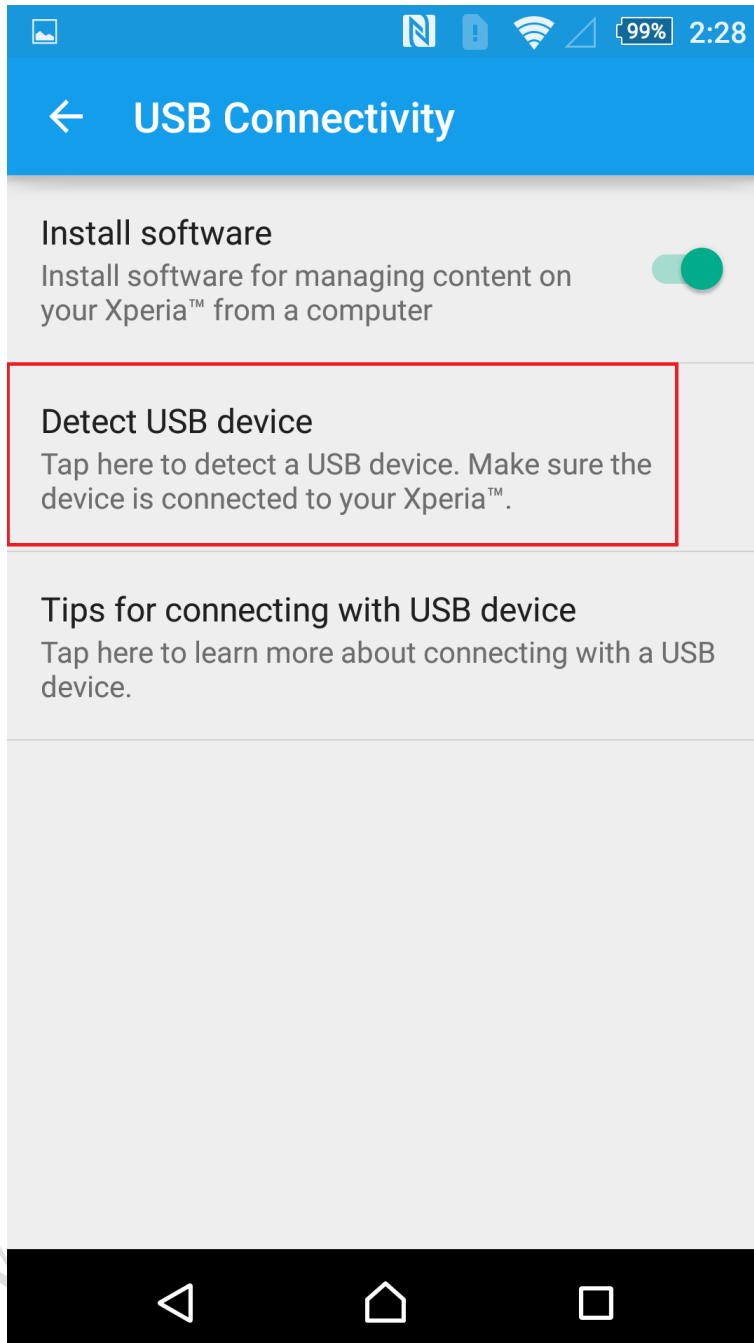

Last modified date	Author	Part	Contact
2015-11-26	Kim sun ah	Development	Say2718@vaultmicro..com

4. Your phone will detect connected USB camera.

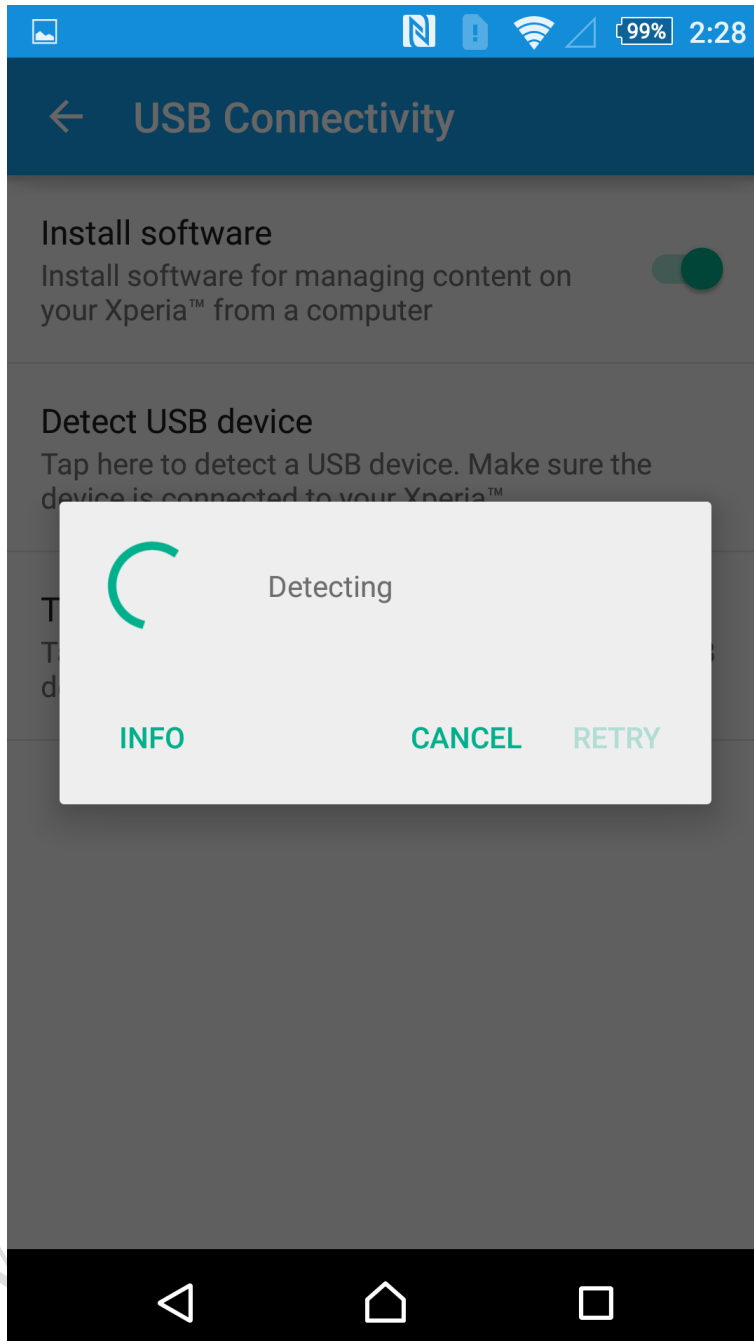

Last modified date	Author	Part	Contact
2015-11-26	Kim sun ah	Development	Say2718@vaultmicro..com

- After some time, CameraFi detects USB camera. If you press OK button, CameraFi will operate.

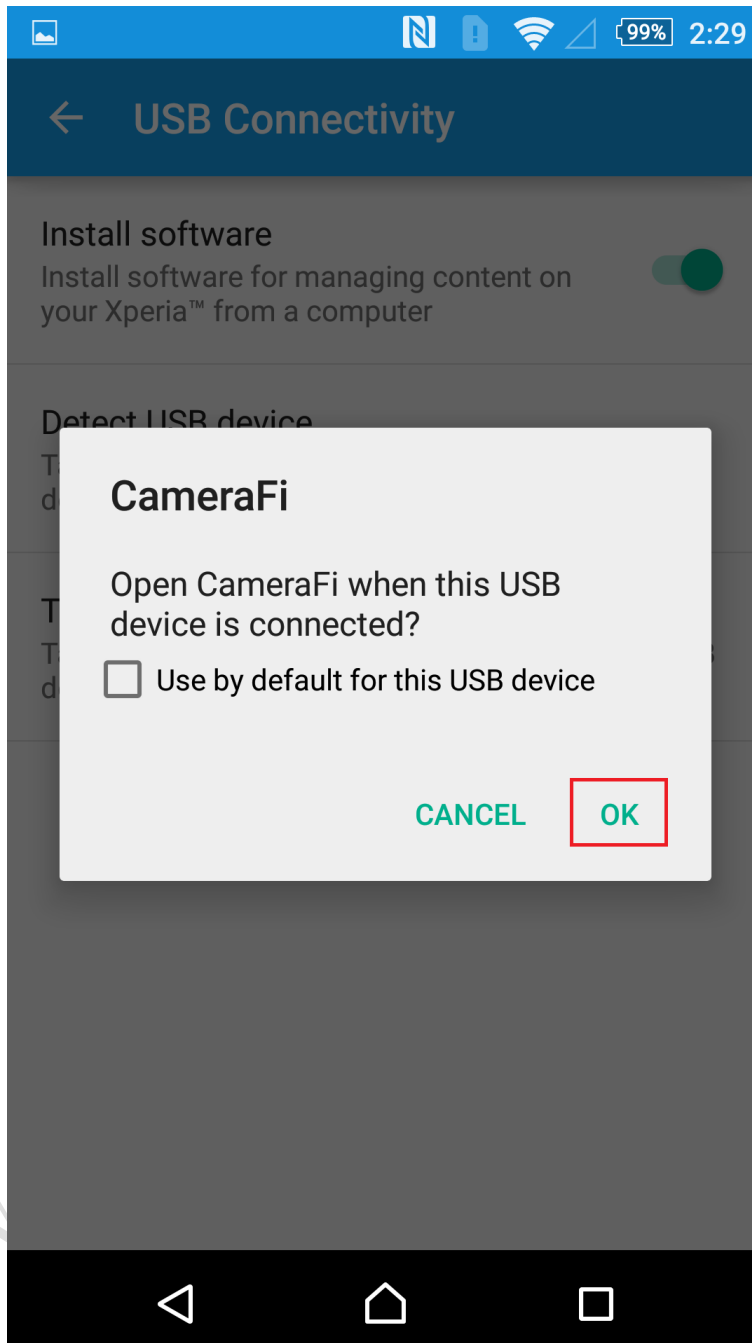

Last modified date	Author	Part	Contact
2015-11-26	Kim sun ah	Development	Say2718@vaultmicro..com

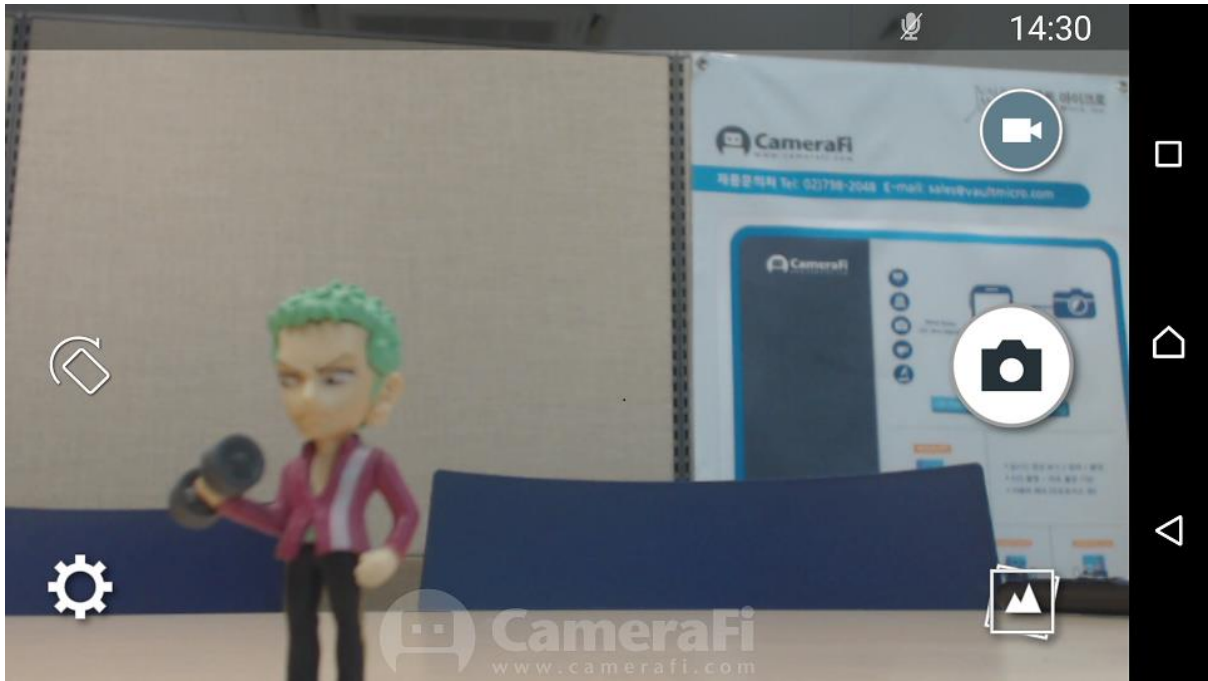

- Image of connecting CameraFi to Sony Xperia Z3+

